

1721 ARM CURL

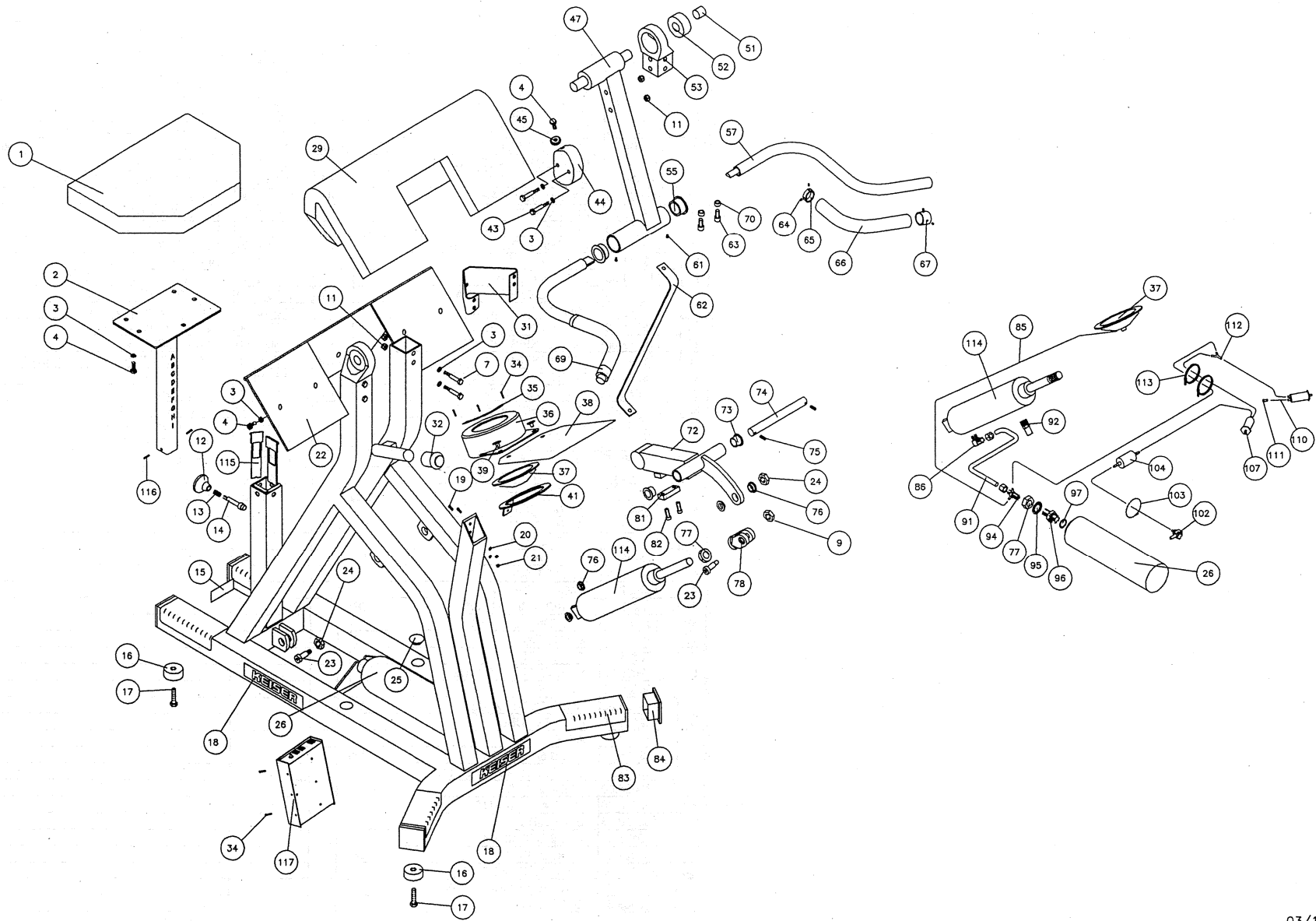

Air 250 Arm Curl

ITEM	PART #	DESCRIPTION	ITEM	PART #	DESCRIPTION
1	250857.00	HEAD CUSHION	69	115438.70	PLUS CAP AZ
2	170904.31	SEAT	70	175054.00	1/2 x 3/8 SLEEVE
3	9353.00	ACFT WSHR 5/16 ZP	71	172205.73	CONNECTOR HALF SHAFT - THD
4	9176.00	HHCS 5/16-18 x 1 ZP	72	170931.33	LEVER ARM BK
6	270912.43	LOOP - SEAT	73	115052.80	FLANGE BEARING .63 I.D.
7	9179.00	HHCS 5/16-18 x 2-1/4 ZP	74	252181.73	TOP PIVOT SHAFT CR
8	172120.73	SEAT LOOP PIN	75	9001.00	SPRING PIN 3/16 x 1/2 ZP
9	9227.00	HX REV LCK NUT 3/8-16 ZP	76	115051.80	FLANGE BEARING .5 I.D.
11	9226.00	HX ELAS LCK NUT 5/16-18 ZP	77	9231.00	HX JAM NUT 3/4-10
12	175420.00	BLACK KNOB	78	115005.00	CLEVIS - 2.5
13	175500.00	SPRING - PLUNGER	81	111896.33	CLAMP W/HOLE
14	172180.80	PLUNGER	82	9109.00	BHHSCS 5/16-24 x 7/8 ZP
15	105443.00	DECAL "SERIAL #"	83	955300.00	4"PROTECTOR STRIP
16	105324.00	BUMPER MOLDED GLIDE	84	115054.00	PLASTIC CAP 2" SQUARE
17	9279.00	HWH TFTDC 5/16-18 x 3/4 ZP	85	953108.00	TUBING - 1/4 BLK URETHANE
18	115372.00	LARGE "KEISER" DECAL	86	8153.00	MALE ELBOW 3/8 x 1/4
19	9262.00	CRPHMS - #10-32 x 0.625	91	953101.00	TUBING 3/8 BLK POLYETHYL
20	9368.00	FLAT WASHER # 10	92	115318.00	EXHAUST MUFFLER 3/8
21	9238.00	HEX NUT # 10-32	94	110832.00	3/8 BARBED STRAIGHT
22	170933.32	MAIN FRM WT	95	9364.00	INT TTH LCK WSHR 3/4 ZP
23	9127.00	SHSB 1/2 x 1 ZP	96	115000.00	TANK BUSHING
25	115404.00	HOLE PLUG 1.0	97	115333.00	ORING .737 x .943 x .103 70 DUR
26	115319.33	TANK 72 IN3 BK	102	110897.00	90 DEG BARBED Q.D.
29	170865.00	ARM CHEST CUSHION	103	115429.00	PLASTIC TIE 10 INCH RED
31	172021.33	ARM REST BRACKET BK	104	115323.00	IN-LINE FILTER
32	135422.00	RUBBER CRUTCH TIP # 20	107	110830.00	THUMB BUTTON VALVE
33	115371.00	SMALL "KEISER" DECAL	110	115312.00	1/4 x 1/8 URETHANE TUBE
35	125303.00	FLANGE DECAL	111	135057.00	BLACK FLOW RESRICTOR
36	175407.00	FLANGED GAGE BOX W/TAB	112	265310.00	PLASTIC Y
37	A600803.60	DIGITAL GAGE ASSY	113	115423.00	PLASTIC TIE 8 INCH BK
	B170800.60	100 PSI ANALOG GAGE ASSY - 1721	114	115317.00	CYLINDER 2-1/2 x 7
39	265404.00	PLASTIC RIVIT	115	505068.80	BUSHING - 4 PIECE
41	171801.33	BRKT - GAGE BOX	116	505063.80	PLASTIC PIN 1/4
43	9178.00	HHCS 5/16-18 x 2 ZP	117	600801.00	PROCESSOR BOX
44	175000.72	CAM			
45	112242.73	CLQMP DISC			
47	170900.33	EX ARM BK			
51	115067.00	1 x 3/4 VINYL CAP BK			
52	115394.00	SPHERICAL BEARING 3/4 I.D.			
53	135407.00	BEARING HOUSING			
55	135050.80	FLANGE BEARING 1" I.D.			
56	172204.73	CONNECTOR HALF SHAFT			
57	173093.32	HANDLE WT			
61	9276.00	FILLISTER SMS TYPE B			
62	175412.00	BELT - A250 27 INCH			
63	9109.00	BHHSCS 5/16-24 x 7/8			
64	9014.00	SOCKET SCR 8-32 x 1/8			
65	115030.00	GRIP COLLAR AZ			
66	165400.60	GRIP SLEEVE 9.75			
67	115439.70	MINUS CAP AZ			
68	115445.80	BUTTON			